

BLACK RUBBER WASHER
OUTSIDE OF FILTER

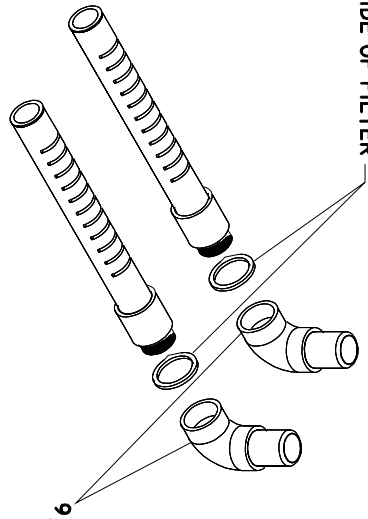

INSERT VINYL SIPHONING TUBE
ITEM G - FIG.1 HERE.

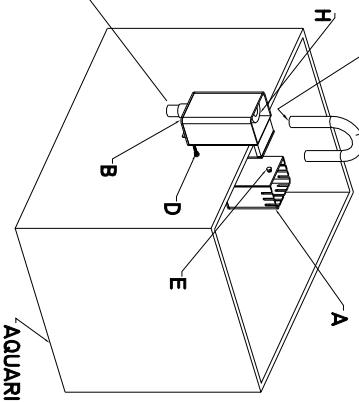

C (NOTE: LONGER SIDE TO ITEM B, SHORTER SIDE TO ITEM A)

CONNECT FLEX HOSE, ITEM 2 - FIGURE 2, HERE.

WITH PRE-FILTER FIGURE 1

PRE-FILTER PARTS LIST

- A. SKIMMER BOX
- B. PRE-FILTER BOX
- C. SIPHON TUBE
- D. 1-1/2" LONG NYLON SCREW
- E. 3/4" LONG NYLON SCREW
- G. VINYL SIPHONING TUBING (NOT SHOWN)
- H. PRE-FILTER SPONGE

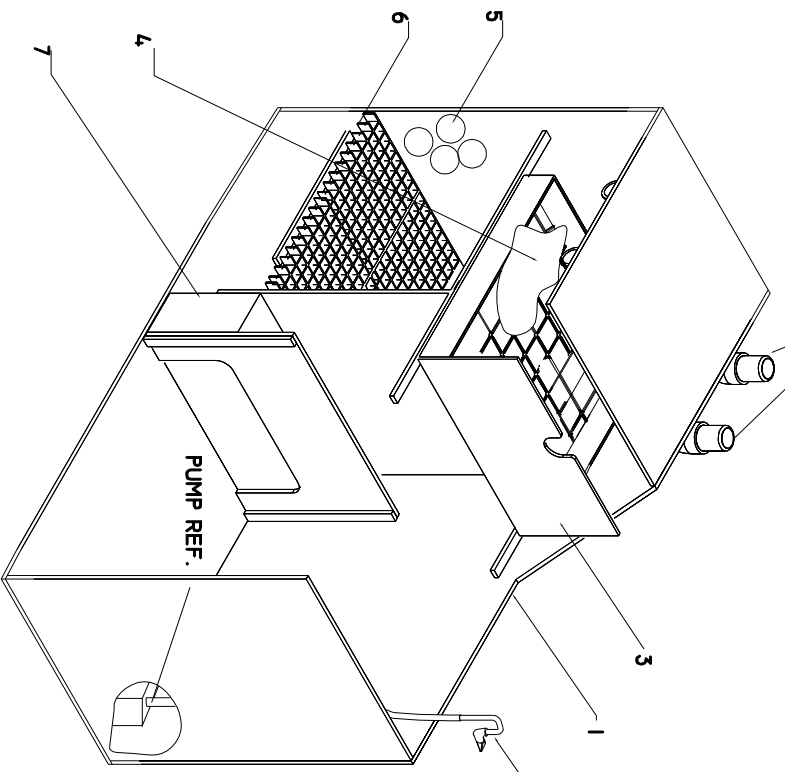

FILTER PARTS LIST

- 1. FILTER BODY
- 2. FLEX HOSE
- 3. DRAWER
- 4. BLUE POLYESTER FILTER
- 5. BLUE BIO-BALLS
- 6. EGG CRATE SHELF
- 7. BLUE FOAM FILTER BLOCK
- 8. CLEAR TUBE WITH DIRECTIONAL RETURN VALVE.
- 9. SPLASH-BAFFLE

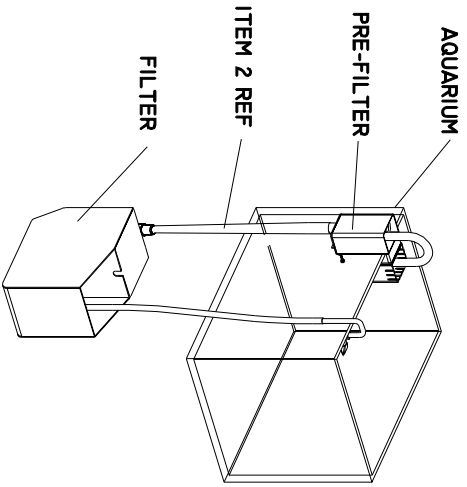

COMPLETE INSTALLATION

Premier 200-400 Figure 2



PREMIER SERIES WET/DRY ASSEMBLY AND INSTALLATION INSTRUCTIONS

The Premier Series Wet/Dry incorporates technologically advanced features. The drawer/drip tray design allows for easy removal and cleaning without removing skimmers from the sump area or turning the system off. The splash-baffle directs water more evenly over drip tray, eliminates splashing and salt-creep and allows for better water dispersion over bagged media. The large drawer/drip tray is deeper and allows for easy placement of bagged media.

ASSEMBLY:

1. Assemble main filter according to the diagram. Make sure that the input splash-Baffle has a black rubber washer on the outside of the filter shell.
2. Place main filter unit under aquarium stand at desired location.
3. The pre-filter consists of two main boxes; one with a white side, drain fitting, foam tube and another all clear with slots. Slide the slotted box onto the white box so that the screw lines up with the slot. Slide all the way on and tighten.
4. Hang pre-filter on back of aquarium and connect one end of the spiral flex hose to the fitting on the bottom of the pre-filter and the other end to the main filter below aquarium. Use a light back and forth motion when attaching hose.
5. Place siphon tube into pre-filter box so that one end is in the small slotted box and the other end is in the larger box alongside the foam pre-filter tube.
6. Connect black adjustable return spout to the supplied vinyl tubing and hang Return spout on the back of the aquarium opposite the pre-filter. Connect the other end of vinyl to return pump (user supplied).

OPERATION:

1. Fill aquarium water until water begins to fill the pre-filter surface skim box.
2. Fill portion of pre-filter box outside of aquarium with water until water begins to drain to main filter below.
3. Insert a small length of airline tubing into siphon tube to about halfway into the bend of tube. The end of the siphon tube with the airline tubing should be placed in the pre-filter box.
4. Start siphon by sucking on opposite end of airline tubing to remove excess air. Water should begin draining from aquarium into filter sump. To remove the airline tubing from siphon tube, pinch the end of the airline tubing to prevent air from being drawn back into the siphon tube. With one hand, hold the siphon tube in the pre-filter and pull the airline tubing out of the siphon tube with the other hand. Any remaining bubbles can be removed by jiggling the siphon tube once the system is running. If siphon tube does not start, go back to Step 1.

5. If sump has not filled with enough water to cover pump, add more water directly to sump.
6. Once pump is covered, start pump. Continue adding water until pump no longer drains sump of filter dry or blows air out of the return spout. Water level in sump should be at the bottom of the biological support plate. Water level in sump should be at the bottom of the biological support plate. Add or remove water as necessary. The indicated water level of your filter is the minimum water level necessary to run this system properly.
7. To check system, turn off pump and let filter system stop. After a few minutes, check the siphon tube in the pre-filter. It should not have lost its siphon. If siphon is lost, make sure the siphon tube is completely down in the box and both ends are in water. With system operational, check the following:

Adjust for desired water level. Raise or lower the pre-filter skimmer box to adjust water level. Add or remove water as required by adjustment. NOTE: The leveling screw at the bottom of the pre-filter is used to bring the surface skim box parallel to the water level. This allows even water flow through all slots in the pre-filter skim box.

If you have a model that uses 2 siphon tubes, and air is accumulating at the top of one or both of the tubes, try removing one siphon tube. Check pre-filter water levels. If running properly, continue to run with only one siphon tube.

MAINTENANCE:

This should be performed as required. Algae should not be allowed to build up on any of the pre-filter parts including the siphon tube. The foam block in the main filter should be removed and rinsed in discard water when doing a water change. Pre-filter sponge should be cleaned at least once a week (every 3 days is best).

Any evaporation taking place in the aquarium will be transferred to the sump area causing the water level to drop in the sump. Fresh water must be added directly to the sump as needed to prevent the system from running dry and to maintain constant salinity.

This Pro Clear Aquatic Systems product is covered by a Limited Lifetime Warranty for the original purchaser against defects in materials or workmanship (receipt required).